

Project Information

Project Name _____

Fixture Number _____

Date _____ Type _____

Description

Envirobrite's ® UL listed FWN narrow wrap fixtures are made of 4' and 8' formed aluminum housings with a variety of reflectors, T8 or T5 lamp holders and an acrylic pattern 8 lens. The result is substantial energy savings, improved lighting, and an enhanced decorative upgrade. All Envirobrite ® fixtures offer a number of specialized reflector materials. In conjunction with numerous ballast and lamp configurations our own FWN fixtures can easily produce ideal IES recommended light levels with minimized energy consumption.

Application

Envirobrite ® narrow wrap fixtures have been a preferred upgrade to retrofit existing narrow wrap and T12 strip fixtures or applying to new construction projects. The FWN fixture is designed for single or continuous row configurations. These fixtures are ideal for schools, office spaces, hospitals, and many other commercial locations.

Design

Envirobrite ® FWN fixtures are made from die formed high grade aluminum housing and end caps. With surface or suspension mounting options our FWN narrow wrap fixture is a flexible approach to any application. Each fixture is manufactured with ample knock outs on the back and both ends of the fixture. All Envirobrite ® fixtures are designed by our expert in house lighting engineers for ideal photometry and trouble-free installation. Every Envirobrite ® fixture is designed to meet UL 1570 specifications for safety. Integral to ideal fixture functionality is the combination of our manufactured reflectors. Envirobrite ® reflectors are fabricated with Energy Planning Associates custom-made multi-stage progressive roll forming machinery. Our unique high speed equipment consistently produces multi-faceted linear fluorescent reflectors within precise quality tolerance. Our process enables us to add additional facets for superior reflector performance significantly reducing production cost and improving lead times. Our rigid, light weight bracketing systems are produced with custom designed stamping dies and are very easy to install.

Quick, safe & Labor Efficient Installation

- Quarter turn reflectors for easy installation
- Snap-in lamp holders won't fall out during overhead installation
- Toolless ballast access for simple maintenance
- Streamlined packaging for easy job site material management
- With 1/3 the weight of steel aluminum components permit reduced shipping cost and simpler installation

LIMITED PRODUCT WARRANTY

Energy Planning Associates warrants for a period of 5 years from the date of purchase that all Envirobrite ® fixtures will be free of defects from manufacturing and workmanship. This warranty excludes damage of any kind resulting from improper installation, misuse, abuse, accidents, or natural disasters. Energy Planning will repair, or at its option, replace the defective product and only when the product is properly handled, installed, and maintained.

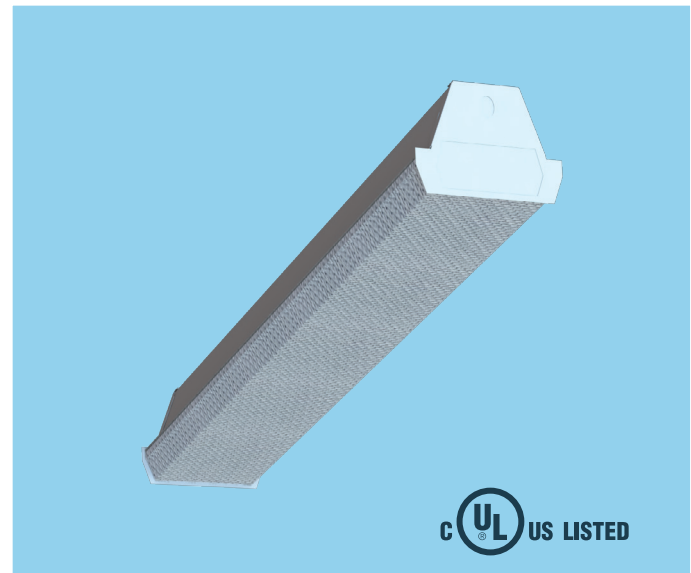

Primary Features & Benefits

- Proudly designed, made and assembled in the USA
- Considerable reduction in energy costs
- UL listed
- 1,2,3,4 and 6 lamp options available
- Aluminum components generate a rust-free approach to less maintenance and lasting appeal
- Aluminum reflector has excellent thermal properties
- Utility rebate friendly throughout the USA
- Significant reduction in maintenance costs
- Easily cleaned
- Optional motion / occupancy sensing and photo-cell technology for further savings

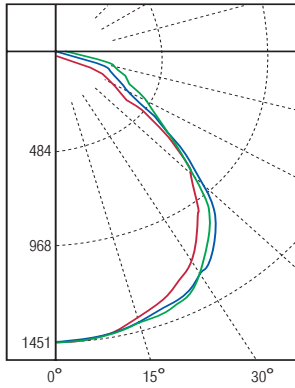

Candela Plot
2 Lamp T8



ZONAL LUMEN SUMMARY

Zone	Lumens	% Lamp	% Luminaire
0 - 30	3015	25.1	28.4
0 - 40	4951	41.3	46.7
0-60	8157	68.0	76.9
0-90	10145	84.5	95.6

Total Luminaire Optical Efficiency = 88.4%
*specs taken using 95% MIRO reflector

Luminaire Spacing Criterion
0 deg - 1.2 | 90 deg - 1.3
Call factory for full photometric report

Wattage

All fixture wattages shown include standard electronic ballast and F32T8 lamps

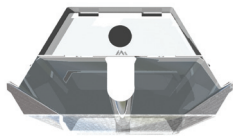

(1) 4' Lamp (30 Input Watts)
(2) 4' Lamps (59 Input Watts)

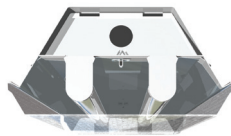

(2) 4' Lamps (59 Input Watts)
(4) 4' Lamps (114 Input Watts)

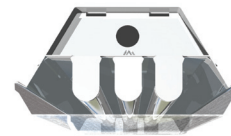

(3) 4' Lamps (87 Input Watts)
(6) 4' Lamps (174 Input Watts)

Fixture Dimensions

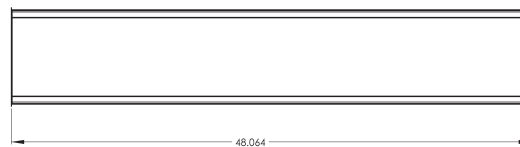
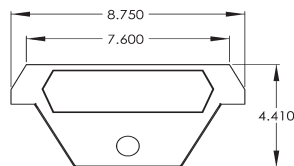

Ordering Information

Sample number: FWN1402T832ENVMVTL12H-L08P8A

Project Fixture Number: _____

Type	Dimension	Lamps	Lamp Type	Reflector	Voltage	T5 Ballast Configuration	T8 Ballast Configuration	Lens
• FWN	• 14 = 1 x 4 • 18 = 1 x 8	• 01 = 1 lamp • 02 = 2 lamp • 03 = 3 lamp • 04 = 4 lamp • 06 = 6 lamp	• T554 = 54W • T832 = 32W	• EN = 95% enhanced • WN = 92% White	• VMVT = 120/277	• L14H = (1) 4 lamp T5 Ballast • L22H = (2) 2 lamp T5 Ballast • M14H12H = (1) 4 LAMP T5 & (1) 2 lamp T5 Ballast	• L11H = (1) 1 lamp T8 HBF Ballast • L12H = (1) 2 lamp T8 HBF Ballast • L13H = (1) 3 lamp T8 HBF Ballast • L14H = (1) 4 lamp T8 HBF Ballast • L22H = (2) 2 lamp T8 HBF Ballast • M14H12H = (1) 4 LAMP T8 HBF & (1) 2 lamp T8 HBF Ballast	• L08P8A = .08 Pattern 8 Acrylic

Contact factory for additional options including: Cord, Emergency Ballast, Wire Cage, Lamps

For added efficiency include high quality T5 or T8 lamps. Adding an Envirobrite® approved motion sensor system to your lighting upgrade project will further enhance energy savings and create an even faster payback

